



CERROPRESS®

# PRICE LIST

VERSION March 2022



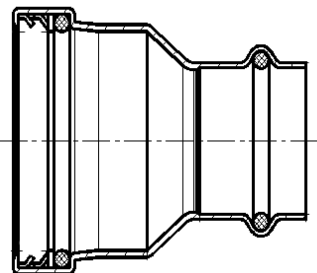
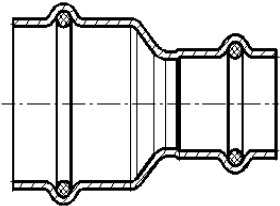
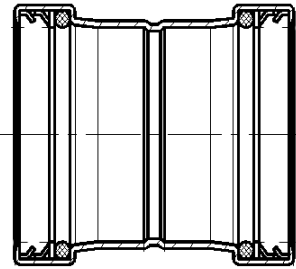
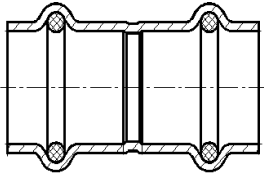

### COUPLING WITH STOP

Part	Size	Type	Bag Qty	Case Qty	Weight EACH (lbs)	List Price EACH (US\$)
10002	1/2"	P x P	10	450	0.080	\$ 4.42
10004	3/4"	P x P	10	240	0.131	\$ 6.89
10006	1"	P x P	5	150	0.163	\$ 13.10
10008	1-1/4"	P x P	1	75	0.243	\$ 17.28
10010	1-1/2"	P x P	1	50	0.474	\$ 31.49
10012	2"	P x P	1	30	0.604	\$ 40.15

### COUPLING WITH STOP XL

10014	2-1/2"	P x P	1	20	1.211	\$ 117.54
10016	3"	P x P	1	16	1.669	\$ 149.75
10018	4"	P x P	1	6	2.882	\$ 211.98

### COUPLING REDUCER

Part	Size	Type	Bag Qty	Case Qty	Weight EACH (lbs)	List Price EACH (US\$)
10102	3/4" x 1/2"	P x P	10	300	0.124	\$ 19.85
10104	1" x 1/2"	P x P	10	200	0.172	\$ 35.97
10106	1" x 3/4"	P x P	10	200	0.177	\$ 23.49
10108	1-1/4" x 1/2"	P x P	1	100	0.257	\$ 84.74
10110	1-1/4" x 3/4"	P x P	1	100	0.258	\$ 53.16
10112	1-1/4" x 1"	P x P	1	80	0.258	\$ 34.30
10114	1-1/2" x 3/4"	P x P	1	75	0.427	\$ 63.51
10116	1-1/2" x 1"	P x P	1	75	0.428	\$ 57.03
10118	1-1/2" x 1-1/4"	P x P	1	60	0.400	\$ 52.28
10120	2" x 3/4"	P x P	1	40	0.595	\$ 60.41
10122	2" x 1"	P x P	1	40	0.591	\$ 89.64
10124	2" x 1-1/4"	P x P	1	40	0.552	\$ 73.18
10126	2" x 1-1/2"	P x P	1	40	0.595	\$ 58.86

### COUPLING REDUCER XL

10128	2-1/2" x 1"	P x P	1	25	0.827	\$ 234.94
10130	2-1/2" x 1-1/4"	P x P	1	25	0.851	\$ 249.04
10132	2-1/2" x 1-1/2"	P x P	1	25	0.986	\$ 246.53
10134	2-1/2" x 2"	P x P	1	25	1.047	\$ 234.11
10135	3" x 1-1/4"	P x P	1	12	1.234	\$ 241.26
10136	3" x 1-1/2"	P x P	1	12	1.246	\$ 275.16
10138	3" x 2"	P x P	1	12	1.290	\$ 275.81
10140	3" x 2-1/2"	P x P	1	12	1.510	\$ 322.83
10142	4" x 2"	P x P	1	8	2.090	\$ 342.83
10144	4" x 2-1/2"	P x P	1	8	2.333	\$ 379.35
10146	4" x 3"	P x P	1	8	2.483	\$ 414.33

# CERROPRESS® PRICE LIST

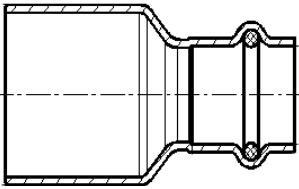

## BUSHING REDUCER

Part	Size	Type	Bag Qty	Case Qty	Weight EACH (lbs)	List Price EACH (US\$)
10202	3/4" x 1/2"	FTG x P	10	350	0.097	\$ 5.27
10204	1" x 1/2"	FTG x P	10	300	0.127	\$ 12.97
10206	1" x 3/4"	FTG x P	10	240	0.144	\$ 13.55
10208	1-1/4" x 1/2"	FTG x P	5	150	0.170	\$ 15.66
10210	1-1/4" x 3/4"	FTG x P	5	150	0.195	\$ 15.92
10212	1-1/4" x 1"	FTG x P	5	150	0.190	\$ 17.91
10214	1-1/2" x 1/2"	FTG x P	1	80	0.319	\$ 47.74
10216	1-1/2" x 3/4"	FTG x P	1	80	0.276	\$ 26.62
10218	1-1/2" x 1"	FTG x P	1	75	0.299	\$ 26.30
10220	1-1/2" x 1-1/4"	FTG x P	1	75	0.298	\$ 26.45
10222	2" x 1/2"	FTG x P	1	50	0.535	\$ 58.16
10224	2" x 3/4"	FTG x P	1	50	0.533	\$ 57.85
10226	2" x 1"	FTG x P	1	50	0.406	\$ 30.15
10228	2" x 1-1/4"	FTG x P	1	50	0.418	\$ 36.48
10230	2" x 1-1/2"	FTG x P	1	40	0.462	\$ 35.87

## BUSHING REDUCER XL

10232	2-1/2" x 1"	FTG x P	1	30	0.754	\$ 122.90
10234	2-1/2" x 1-1/4"	FTG x P	1	30	0.743	\$ 176.29
10236	2-1/2" x 1-1/2"	FTG x P	1	30	0.884	\$ 173.07
10238	2-1/2" x 2"	FTG x P	1	30	0.775	\$ 147.51
10240	3" x 1-1/4"	FTG x P	1	15	1.008	\$ 199.45
10242	3" x 1-1/2"	FTG x P	1	15	1.158	\$ 189.84
10244	3" x 2"	FTG x P	1	15	0.886	\$ 184.92
10246	3" x 2-1/2"	FTG x P	1	15	1.191	\$ 189.61
10248	4" x 2"	FTG x P	1	10	1.885	\$ 213.91
10250	4" x 2-1/2"	FTG x P	1	10	2.117	\$ 231.98
10252	4" x 3"	FTG x P	1	10	2.297	\$ 243.76

## 90 ELBOW

Part	Size	Type	Bag Qty	Case Qty	Weight EACH (lbs)	List Price EACH (US\$)
10302	1/2"	P x P	10	350	0.112	\$ 5.38
10304	3/4"	P x P	10	200	0.165	\$ 8.81
10306	1"	P x P	5	100	0.279	\$ 15.92
10308	1-1/4"	P x P	1	55	0.396	\$ 31.55
10310	1-1/2"	P x P	1	35	0.705	\$ 59.53
10312	2"	P x P	1	15	1.149	\$ 84.35

## 90 ELBOW XL

10314	2-1/2"	P x P	1	8	2.102	\$ 235.01
10316	3"	P x P	1	5	3.032	\$ 298.85
10318	4"	P x P	1	2	5.726	\$ 365.46

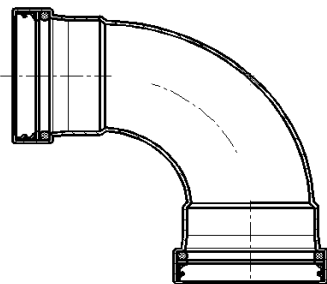
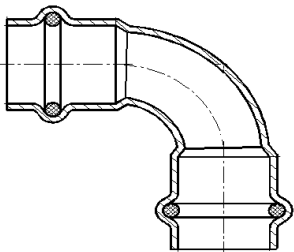
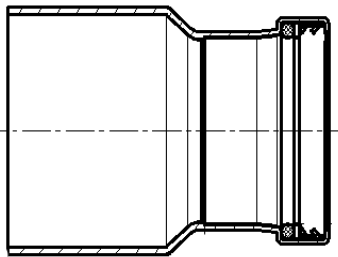

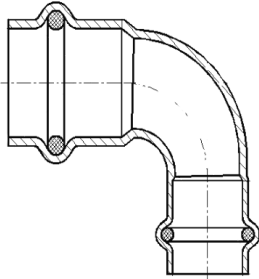

90 ELBOW REDUCING						
Part	Size	Type	Bag Qty	Case Qty	Weight EACH (lbs)	List Price EACH (US\$)
10320	3/4" x 1/2"	P x P	15	210	0.153	\$ 11.75
10322	1" x 3/4"	P x P	10	80	0.251	\$ 26.94

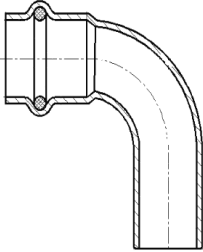

90 STREET ELBOW						
Part	Size	Type	Bag Qty	Case Qty	Weight EACH (lbs)	List Price EACH (US\$)
10402	1/2"	P x FTG	10	400	0.104	\$ 5.23
10404	3/4"	P x FTG	10	200	0.156	\$ 8.47
10406	1"	P x FTG	5	120	0.269	\$ 18.16
10408	1-1/4"	P x FTG	1	55	0.374	\$ 33.77
10410	1-1/2"	P x FTG	1	35	0.672	\$ 61.40
10412	2"	P x FTG	1	15	1.105	\$ 85.30

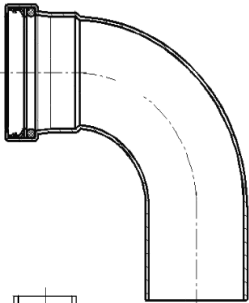

90 STREET ELBOW XL						
Part	Size	Type	Bag Qty	Case Qty	Weight EACH (lbs)	List Price EACH (US\$)
10414	2-1/2"	P x FTG	1	10	1.958	\$ 264.34
10416	3"	P x FTG	1	5	2.862	\$ 307.90
10418	4"	P x FTG	1	2	5.513	\$ 391.12

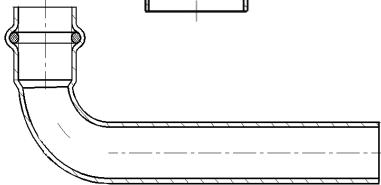

90 EXTENDED STREET ELBOW						
Part	Size	Type	Bag Qty	Case Qty	Weight EACH (lbs)	List Price EACH (US\$)
10420	3/4"	P x FTG	5	100	0.386	\$ 50.49

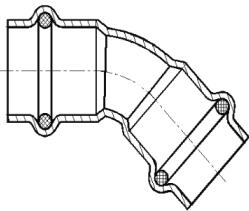

45 ELBOW						
Part	Size	Type	Bag Qty	Case Qty	Weight EACH (lbs)	List Price EACH (US\$)
10702	1/2"	P x P	10	400	0.091	\$ 5.78
10704	3/4"	P x P	10	200	0.143	\$ 7.42
10706	1"	P x P	5	120	0.219	\$ 21.68
10708	1-1/4"	P x P	1	70	0.320	\$ 30.98
10710	1-1/2"	P x P	1	40	0.617	\$ 49.65
10712	2"	P x P	1	25	0.840	\$ 68.86

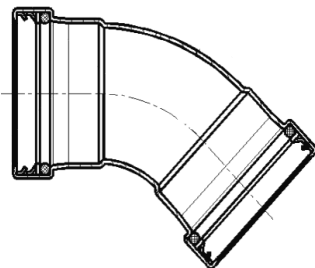

45 ELBOW XL						
Part	Size	Type	Bag Qty	Case Qty	Weight EACH (lbs)	List Price EACH (US\$)
10714	2-1/2"	P x P	1	12	1.610	\$ 153.54
10716	3"	P x P	1	6	2.337	\$ 215.17
10718	4"	P x P	1	2	4.216	\$ 321.41

# CERROPRESS® PRICE LIST

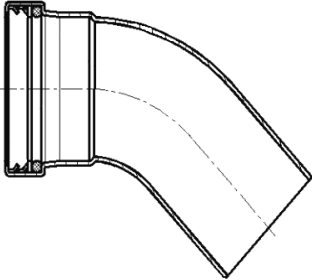
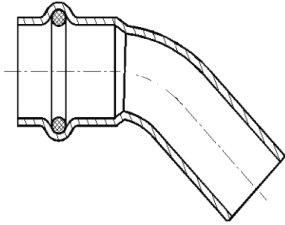

## 45 STREET ELBOW

Part	Size	Type	Bag Qty	Case Qty	Weight EACH (lbs)	List Price EACH (US\$)
10802	1/2"	P x FTG	10	450	0.085	\$ 4.78
10804	3/4"	P x FTG	10	200	0.145	\$ 7.12
10806	1"	P x FTG	5	140	0.200	\$ 20.86
10808	1-1/4"	P x FTG	1	70	0.311	\$ 31.00
10810	1-1/2"	P x FTG	1	40	0.591	\$ 48.53
10812	2"	P x FTG	1	25	0.815	\$ 71.30

## 45 STREET ELBOW XL

10814	2-1/2"	P x FTG	1	12	1.555	\$ 195.28
10816	3"	P x FTG	1	6	2.192	\$ 282.92
10818	4"	P x FTG	1	4	4.020	\$ 357.27

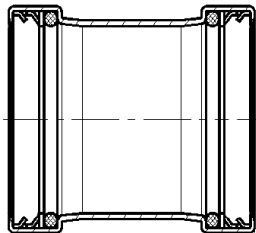
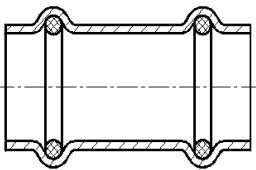

## COUPLING NO STOP

Part	Size	Type	Bag Qty	Case Qty	Weight EACH (lbs)	List Price EACH (US\$)
11102	1/2"	P x P	10	450	0.080	\$ 10.81
11104	3/4"	P x P	10	240	0.131	\$ 13.82
11106	1"	P x P	5	150	0.163	\$ 18.05
11108	1-1/4"	P x P	1	75	0.241	\$ 27.31
11110	1-1/2"	P x P	1	50	0.472	\$ 41.26
11112	2"	P x P	1	30	0.593	\$ 47.13

## COUPLING NO STOP XL

11114	2-1/2"	P x P	1	20	1.202	\$ 115.15
11116	3"	P x P	1	16	1.665	\$ 153.97
11118	4"	P x P	1	6	2.867	\$ 210.61

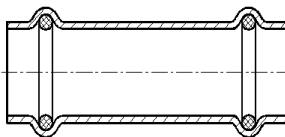

## EXTENDED COUPLING NO STOP

Part	Size	Type	Bag Qty	Case Qty	Weight EACH (lbs)	List Price EACH (US\$)
11202	1/2"	P x P	5	225	0.136	\$ 32.08
11204	3/4"	P x P	5	120	0.209	\$ 36.89
11206	1"	P x P	5	75	0.284	\$ 46.23
11208	1-1/4"	P x P	1	36	0.394	\$ 59.67
11210	1-1/2"	P x P	1	25	0.680	\$ 86.31
11212	2"	P x P	1	15	0.900	\$ 104.28



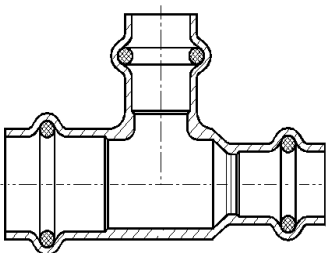
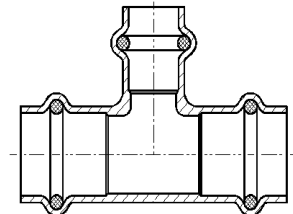
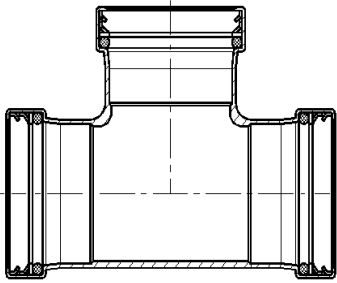
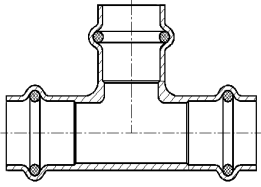

### TEE - EQUAL LEGS

Part	Size	Type	Bag Qty	Case Qty	Weight EACH (lbs)	List Price EACH (US\$)
11302	1/2"	P x P x P	10	200	0.165	\$ 8.25
11304	3/4"	P x P x P	10	100	0.286	\$ 14.49
11306	1"	P x P x P	5	60	0.396	\$ 24.22
11308	1-1/4"	P x P x P	1	40	0.518	\$ 39.83
11310	1-1/2"	P x P x P	1	25	0.881	\$ 75.82
11312	2"	P x P x P	1	15	1.102	\$ 93.70

### TEE - EQUAL LEGS XL

11314	2-1/2"	P x P x P	1	6	2.293	\$ 298.10
11316	3"	P x P x P	1	4	3.252	\$ 366.10
11318	4"	P x P x P	1	2	5.843	\$ 527.51

### TEE - REDUCER BRANCH

Part	Size	Type	Bag Qty	Case Qty	Weight EACH (lbs)	List Price EACH (US\$)
11402	1/2" x 1/2" x 3/4"	P x P x P	10	150	0.287	\$ 26.70
11404	1/2" x 1/2" x 1"	P x P x P	5	100	0.320	\$ 37.15
11410	3/4" x 3/4" x 1/2"	P x P x P	10	120	0.242	\$ 12.19
11412	3/4" x 3/4" x 1"	P x P x P	5	80	0.400	\$ 41.74
11424	1" x 1" x 1/2"	P x P x P	5	80	0.375	\$ 27.90
11426	1" x 1" x 3/4"	P x P x P	5	80	0.410	\$ 27.82
11428	1" x 1" x 1-1/4"	P x P x P	1	50	0.568	\$ 72.52
11448	1-1/4" x 1-1/4" x 1/2"	P x P x P	1	50	0.471	\$ 35.87
11450	1-1/4" x 1-1/4" x 3/4"	P x P x P	1	50	0.512	\$ 37.73
11452	1-1/4" x 1-1/4" x 1"	P x P x P	1	50	0.554	\$ 40.70
11466	1-1/2" x 1-1/2" x 1/2"	P x P x P	1	40	0.702	\$ 82.27
11468	1-1/2" x 1-1/2" x 3/4"	P x P x P	1	35	0.808	\$ 69.75
11470	1-1/2" x 1-1/2" x 1"	P x P x P	1	30	0.849	\$ 72.38
11472	1-1/2" x 1-1/2" x 1-1/4"	P x P x P	1	30	0.893	\$ 77.73
11488	2" x 2" x 1/2"	P x P x P	1	25	0.881	\$ 129.66
11490	2" x 2" x 3/4"	P x P x P	1	25	0.925	\$ 109.63
11492	2" x 2" x 1"	P x P x P	1	20	0.992	\$ 113.30
11494	2" x 2" x 1-1/4"	P x P x P	1	20	1.058	\$ 115.47
11496	2" x 2" x 1-1/2"	P x P x P	1	16	1.102	\$ 89.89

### TEE - REDUCER

Part	Size	Type	Bag Qty	Case Qty	Weight EACH (lbs)	List Price EACH (US\$)
11406	3/4" x 1/2" x 1/2"	P x P x P	10	120	0.278	\$ 20.19
11408	3/4" x 1/2" x 3/4"	P x P x P	5	100	0.326	\$ 21.77
11413	1" x 1/2" x 1/2"	P x P x P	5	80	0.399	\$ 46.77
11414	1" x 1/2" x 3/4"	P x P x P	5	80	0.400	\$ 63.49

# CERROPRESS® PRICE LIST

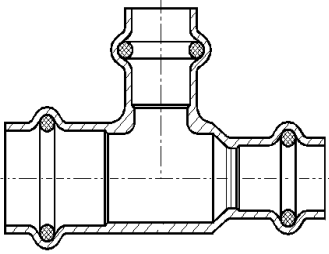

## TEE - REDUCER continued

11416	1" x 1/2" x 1"	P x P x P	5	70	0.463	\$ 41.44
11418	1" x 3/4" x 1/2"	P x P x P	5	80	0.368	\$ 42.26
11420	1" x 3/4" x 3/4"	P x P x P	5	80	0.403	\$ 38.47
11422	1" x 3/4" x 1"	P x P x P	5	70	0.453	\$ 43.46
11430	1-1/4" x 3/4" x 1/2"	P x P x P	1	50	0.467	\$ 66.67
11432	1-1/4" x 3/4" x 3/4"	P x P x P	1	50	0.531	\$ 72.34
11434	1-1/4" x 3/4" x 1"	P x P x P	1	50	0.561	\$ 75.23
11436	1-1/4" x 1/2" x 1-1/4"	P x P x P	1	50	0.600	\$ 82.89
11438	1-1/4" x 3/4" x 1-1/4"	P x P x P	1	40	0.610	\$ 66.56
11440	1-1/4" x 1" x 1/2"	P x P x P	1	60	0.457	\$ 51.59
11442	1-1/4" x 1" x 3/4"	P x P x P	1	60	0.462	\$ 41.31
11444	1-1/4" x 1" x 1"	P x P x P	1	50	0.507	\$ 45.31
11446	1-1/4" x 1" x 1-1/4"	P x P x P	1	40	0.617	\$ 120.53
11454	1-1/2" x 1" x 3/4"	P x P x P	1	40	0.763	\$ 102.68
11456	1-1/2" x 1" x 1"	P x P x P	1	40	0.806	\$ 115.52
11458	1-1/2" x 1" x 1-1/2"	P x P x P	1	30	1.097	\$ 126.72
11460	1-1/2" x 1-1/4" x 3/4"	P x P x P	1	30	0.744	\$ 88.80
11462	1-1/2" x 1-1/4" x 1"	P x P x P	1	30	0.806	\$ 102.97
11464	1-1/2" x 1-1/4" x 1-1/4"	P x P x P	1	30	0.856	\$ 78.75
11465	1-1/2" x 1-1/4" x 1-1/2"	P x P x P	1	25	0.881	\$ 86.74
11474	2" x 1" x 1"	P x P x P	1	20	1.173	\$ 120.77
11476	2" x 1-1/4" x 1-1/4"	P x P x P	1	20	1.173	\$ 169.22
11478	2" x 1-1/2" x 3/4"	P x P x P	1	15	1.021	\$ 145.12
11480	2" x 1-1/2" x 1"	P x P x P	1	15	1.097	\$ 143.25
11482	2" x 1-1/2" x 1-1/4"	P x P x P	1	15	1.234	\$ 147.96
11484	2" x 1-1/2" x 1-1/2"	P x P x P	1	15	1.360	\$ 152.01
11486	2" x 1-1/2" x 2"	P x P x P	1	10	1.322	\$ 139.67

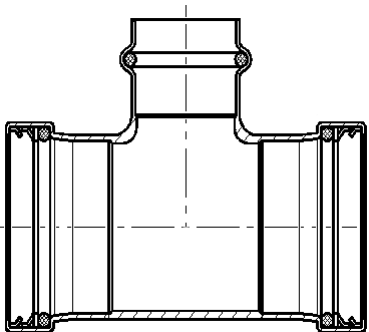

## TEE - REDUCER BRANCH XL

Part	Size	Type	Bag Qty	Case Qty	Weight EACH (lbs)	List Price EACH (US\$)
11522	2-1/2" x 2-1/2" x 1/2"	P x P x P	1	6	1.484	\$ 385.15
11524	2-1/2" x 2-1/2" x 3/4"	P x P x P	1	6	1.464	\$ 409.86
11526	2-1/2" x 2-1/2" x 1"	P x P x P	1	6	1.521	\$ 411.85
11528	2-1/2" x 2-1/2" x 1-1/4"	P x P x P	1	6	1.632	\$ 414.41
11530	2-1/2" x 2-1/2" x 1-1/2"	P x P x P	1	6	1.810	\$ 392.60
11532	2-1/2" x 2-1/2" x 2"	P x P x P	1	6	1.940	\$ 348.27
11554	3" x 3" x 1/2"	P x P x P	1	4	1.945	\$ 482.80
11556	3" x 3" x 3/4"	P x P x P	1	4	1.985	\$ 439.97
11558	3" x 3" x 1"	P x P x P	1	4	2.064	\$ 437.96
11560	3" x 3" x 1-1/4"	P x P x P	1	4	2.130	\$ 441.96
11562	3" x 3" x 1-1/2"	P x P x P	1	4	2.328	\$ 439.96
11564	3" x 3" x 2"	P x P x P	1	4	2.500	\$ 421.08
11566	3" x 3" x 2-1/2"	P x P x P	1	4	2.904	\$ 446.88

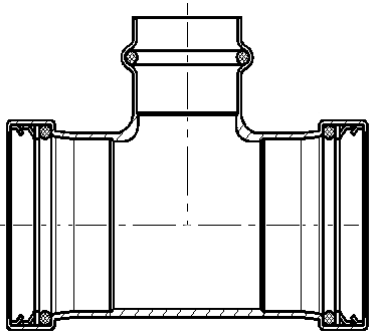

TEE - REDUCER BRANCH XL continued						
11572	4" x 4" x 1/2"	P x P x P	1	2	3.374	\$ 652.94
11574	4" x 4" x 3/4"	P x P x P	1	2	3.400	\$ 645.63
11576	4" x 4" x 1"	P x P x P	1	2	3.654	\$ 478.47
11578	4" x 4" x 1-1/4"	P x P x P	1	2	3.667	\$ 581.10
11580	4" x 4" x 1-1/2"	P x P x P	1	2	3.793	\$ 528.83
11582	4" x 4" x 2"	P x P x P	1	2	4.022	\$ 475.76
11584	4" x 4" x 2-1/2"	P x P x P	1	2	4.536	\$ 458.27
11586	4" x 4" x 3"	P x P x P	1	2	4.855	\$ 498.03

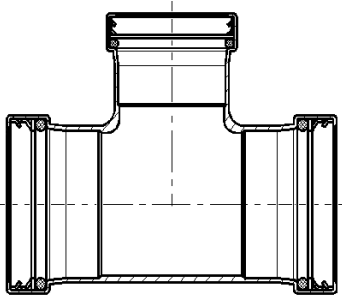

TEE - REDUCER XL						
Part	Size	Type	Bag Qty	Case Qty	Weight EACH (lbs)	List Price EACH (US\$)
11502	2-1/2" x 3/4" x 2-1/2"	P x P x P	1	6	2.059	\$ 469.72
11504	2-1/2" x 1" x 2-1/2"	P x P x P	1	6	2.015	\$ 487.34
11506	2-1/2" x 1-1/4" x 2-1/2"	P x P x P	1	6	2.082	\$ 491.82
11508	2-1/2" x 1-1/2" x 2-1/2"	P x P x P	1	6	2.205	\$ 431.94
11510	2-1/2" x 2" x 3/4"	P x P x P	1	6	1.398	\$ 432.07
11512	2-1/2" x 2" x 1"	P x P x P	1	6	1.424	\$ 422.31
11514	2-1/2" x 2" x 1-1/4"	P x P x P	1	6	1.587	\$ 314.25
11516	2-1/2" x 2" x 1-1/2"	P x P x P	1	6	1.671	\$ 382.03
11518	2-1/2" x 2" x 2"	P x P x P	1	6	1.841	\$ 358.16
11520	2-1/2" x 2" x 2-1/2"	P x P x P	1	6	2.170	\$ 452.19
11534	3" x 3/4" x 3"	P x P x P	1	5	2.955	\$ 472.43
11536	3" x 1" x 3"	P x P x P	1	5	2.886	\$ 503.24
11538	3" x 1-1/4" x 3"	P x P x P	1	5	2.928	\$ 611.43
11540	3" x 1-1/2" x 3"	P x P x P	1	5	3.045	\$ 518.30
11542	3" x 2" x 2"	P x P x P	1	5	2.331	\$ 479.89
11544	3" x 2" x 2-1/2"	P x P x P	1	4	2.606	\$ 516.52
11546	3" x 2" x 3"	P x P x P	1	4	2.955	\$ 529.37
11548	3" x 2-1/2" x 2"	P x P x P	1	4	2.467	\$ 493.70
11550	3" x 2-1/2" x 2-1/2"	P x P x P	1	4	2.867	\$ 542.04
11552	3" x 2-1/2" x 3"	P x P x P	1	4	3.184	\$ 541.75
11568	4" x 3" x 2"	P x P x P	1	2	4.040	\$ 667.23
11570	4" x 3" x 3"	P x P x P	1	2	4.917	\$ 669.17

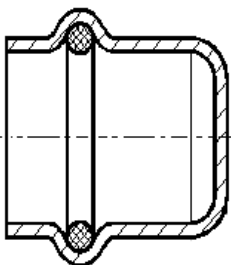

CAP						
Part	Size	Type	Bag Qty	Case Qty	Weight EACH (lbs)	List Price EACH (US\$)
13702	1/2"	P	10	1000	0.056	\$ 9.25
13704	3/4"	P	10	500	0.088	\$ 15.82
13706	1"	P	5	300	0.117	\$ 24.28
13708	1-1/4"	P	1	100	0.185	\$ 28.60
13710	1-1/2"	P	1	90	0.330	\$ 44.32
13712	2"	P	1	50	0.436	\$ 53.87



# CERROPRESS® PRICE LIST

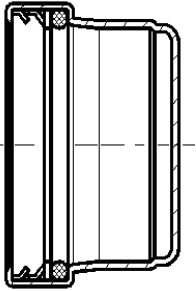

CAP XL						
Part	Size	Type	Bag Qty	Case Qty	Weight EACH (lbs)	List Price EACH (US\$)
13714	2-1/2"	P	1	30	0.739	\$ 165.56
13716	3"	P	1	20	1.025	\$ 212.22
13718	4"	P	1	15	1.852	\$ 247.94

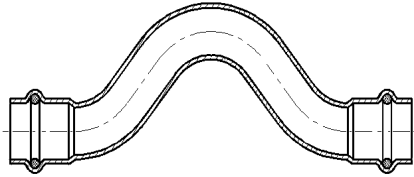

CROSS OVER						
Part	Size	Type	Bag Qty	Case Qty	Weight EACH (lbs)	List Price EACH (US\$)
13802	1/2"	P x P	10	150	0.237	\$ 32.89
13804	3/4"	P x P	10	80	0.413	\$ 41.44

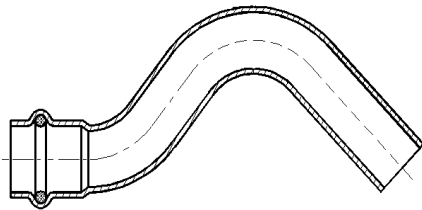

STREET CROSS OVER						
Part	Size	Type	Bag Qty	Case Qty	Weight EACH (lbs)	List Price EACH (US\$)
14802	1/2"	FTG x P	10	150	0.185	\$ 37.62
14804	3/4"	FTG x P	10	80	0.321	\$ 46.45

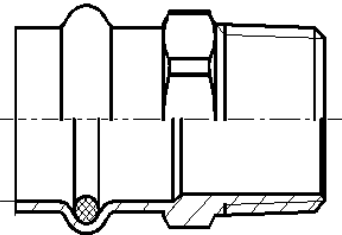

MALE ADAPTER						
Part	Size	Type	Bag Qty	Case Qty	Weight EACH (lbs)	List Price EACH (US\$)
30102	1/2"	P x MPT	10	300	0.110	\$ 6.02
30104	3/4"	P x MPT	10	200	0.190	\$ 10.91
30106	1"	P x MPT	10	160	0.280	\$ 19.17
30108	1-1/4"	P x MPT	1	100	0.370	\$ 40.58
30110	1-1/2"	P x MPT	1	55	0.630	\$ 57.28
30112	2"	P x MPT	1	35	0.890	\$ 110.50
30120	1/2" x 3/8"	P x MPT	10	500	0.080	\$ 9.16
30122	1/2" x 3/4"	P x MPT	10	250	0.190	\$ 11.86
30124	3/4" x 1/2"	P x MPT	10	200	0.170	\$ 12.41
30126	3/4" x 1"	P x MPT	10	160	0.300	\$ 28.28
30128	1" x 1/2"	P x MPT	10	200	0.310	\$ 121.76
30130	1" x 3/4"	P x MPT	10	120	0.240	\$ 31.17
30132	1" x 1-1/4"	P x MPT	1	100	0.450	\$ 39.51
30134	1-1/4" x 1"	P x MPT	1	100	0.340	\$ 44.64
30136	1-1/4" x 1-1/2"	P x MPT	1	50	0.590	\$ 47.67
30138	1-1/2" x 1-1/4"	P x MPT	1	75	0.590	\$ 59.87
30140	1-1/2" x 2"	P x MPT	1	40	1.000	\$ 131.07
30142	2" x 1-1/2"	P x MPT	1	50	0.920	\$ 108.71

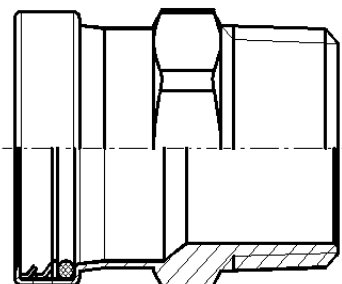

MALE ADAPTER XL						
Part	Size	Type	Bag Qty	Case Qty	Weight EACH (lbs)	List Price EACH (US\$)
30114	2-1/2"	P x MPT	1	24	1.620	\$ 245.23
30116	3"	P x MPT	1	16	2.230	\$ 308.54
30118	4"	P x MPT	1	6	3.820	\$ 377.34

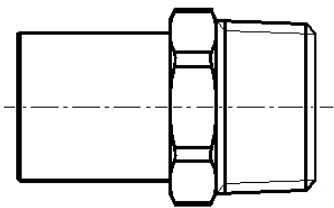
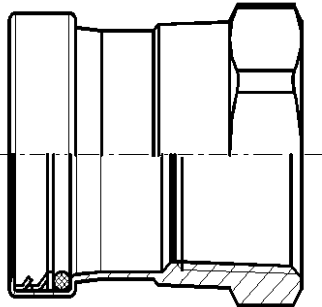
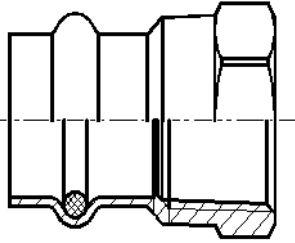

**FEMALE ADAPTER**

Part	Size	Type	Bag Qty	Case Qty	Weight EACH (lbs)	List Price EACH (US\$)
30202	1/2"	P x FPT	10	300	0.100	\$ 7.25
30204	3/4"	P x FPT	10	200	0.170	\$ 11.39
30206	1"	P x FPT	10	160	0.250	\$ 21.79
30208	1-1/4"	P x FPT	1	75	0.340	\$ 48.28
30210	1-1/2"	P x FPT	1	55	0.530	\$ 67.60
30212	2"	P x FPT	1	35	0.780	\$ 112.57
30220	1/2" x 3/8"	P x FPT	10	500	0.090	\$ 8.51
30222	1/2" x 3/4"	P x FPT	10	250	0.150	\$ 14.95
30224	3/4" x 1/2"	P x FPT	10	200	0.170	\$ 10.93
30226	1" x 1/2"	P x FPT	10	150	0.290	\$ 38.61
30228	1" x 3/4"	P x FPT	10	120	0.220	\$ 39.20
30230	1" x 1-1/4"	P x FPT	1	100	0.460	\$ 40.36
30232	1-1/4" x 1"	P x FPT	1	100	0.290	\$ 48.71
30234	1-1/4" x 1-1/2"	P x FPT	1	50	0.620	\$ 65.74
30236	1-1/2" x 1-1/4"	P x FPT	1	50	0.460	\$ 68.58

**FEMALE ADAPTER XL**

30214	2-1/2"	P x FPT	1	25	1.600	\$ 276.83
30216	3"	P x FPT	1	16	2.200	\$ 453.39
30218	4"	P x FPT	1	8	3.800	\$ 568.38

**MALE STREET ADAPTER**

Part	Size	Type	Bag Qty	Case Qty	Weight EACH (lbs)	List Price EACH (US\$)
30302	1/2"	FTG x MPT	5	500	0.107	\$ 20.35
30304	3/4"	FTG x MPT	5	300	0.155	\$ 33.91
30306	1"	FTG x MPT	5	200	0.242	\$ 50.68
30308	1-1/4"	FTG x MPT	1	100	0.505	\$ 66.84
30310	1-1/2"	FTG x MPT	1	60	0.594	\$ 99.66
30312	2"	FTG x MPT	1	30	0.911	\$ 144.71
30314	1/2" x 3/8"	FTG x MPT	5	500	0.069	\$ 22.32
30316	1/2" x 3/4"	FTG x MPT	5	400	0.157	\$ 33.39
30318	3/4" x 1/2"	FTG x MPT	5	400	0.103	\$ 33.74
30320	1" x 3/4"	FTG x MPT	5	200	0.177	\$ 51.65

# CERROPRESS® PRICE LIST

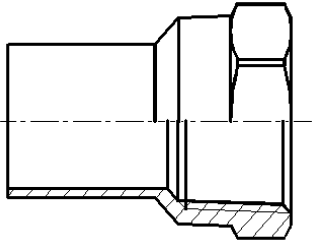

## FEMALE STREET ADAPTER

Part	Size	Type	Bag Qty	Case Qty	Weight EACH (lbs)	List Price EACH (US\$)
30402	1/2"	FTG x FPT	5	400	0.106	\$ 22.31
30404	3/4"	FTG x FPT	5	300	0.146	\$ 31.89
30406	1"	FTG x FPT	1	120	0.273	\$ 50.05
30408	1-1/4"	FTG x FPT	1	100	0.402	\$ 87.29
30410	1-1/2"	FTG x FPT	1	60	0.527	\$ 96.44
30412	2"	FTG x FPT	1	40	0.845	\$ 164.02
30414	1/2" x 3/8"	FTG x FPT	5	500	0.071	\$ 24.62
30416	1/2" x 3/4"	FTG x FPT	5	300	0.142	\$ 25.06
30418	3/4" x 1/2"	FTG x FPT	5	300	0.112	\$ 29.00
30420	1" x 1/2"	FTG x FPT	1	200	0.179	\$ 48.43
30422	1-1/4" x 1/2"	FTG x FPT	1	150	0.278	\$ 81.72

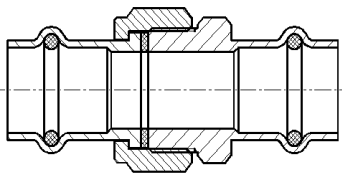

## UNION PXP

Part	Size	Type	Bag Qty	Case Qty	Weight EACH (lbs)	List Price EACH (US\$)
30502	1/2"	P x P	1	150	0.331	\$ 38.51
30504	3/4"	P x P	1	70	0.488	\$ 47.71
30506	1"	P x P	1	50	0.862	\$ 77.65
30508	1-1/4"	P x P	1	50	1.071	\$ 112.81
30510	1-1/2"	P x P	1	25	1.760	\$ 147.63
30512	2"	P x P	1	20	2.885	\$ 239.48

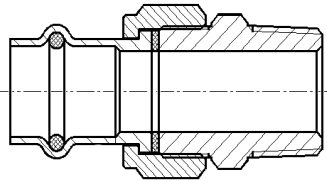

## UNION PXMPT

Part	Size	Type	Bag Qty	Case Qty	Weight EACH (lbs)	List Price EACH (US\$)
30602	1/2"	P x MPT	1	150	0.309	\$ 33.60
30604	3/4"	P x MPT	1	70	0.495	\$ 46.49
30606	1"	P x MPT	1	50	0.888	\$ 68.00
30608	1-1/4"	P x MPT	1	50	1.130	\$ 98.44
30610	1-1/2"	P x MPT	1	25	1.601	\$ 137.30
30612	2"	P x MPT	1	20	2.844	\$ 179.52

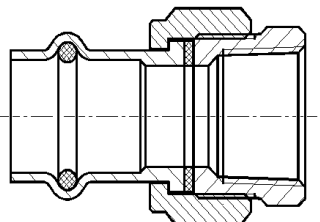

## UNION PXFPT

Part	Size	Type	Bag Qty	Case Qty	Weight EACH (lbs)	List Price EACH (US\$)
30702	1/2"	P x FPT	1	150	0.290	\$ 30.84
30704	3/4"	P x FPT	1	70	0.414	\$ 39.60
30706	1"	P x FPT	1	50	0.802	\$ 65.60
30708	1-1/4"	P x FPT	1	50	0.970	\$ 81.37
30710	1-1/2"	P x FPT	1	25	1.680	\$ 127.90
30712	2"	P x FPT	1	20	2.850	\$ 169.41

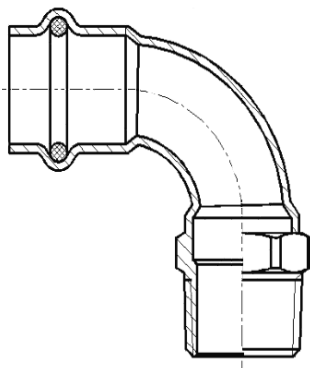
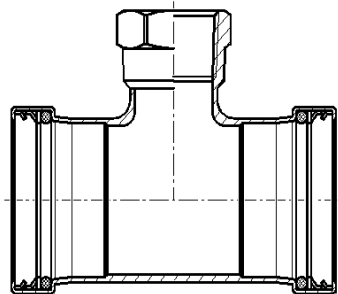
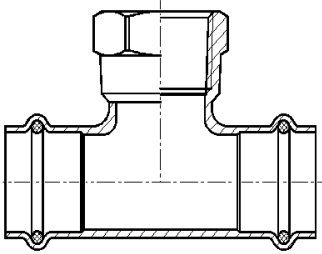

**TEE - ADAPTER**

Part	Size	Type	Bag Qty	Case Qty	Weight EACH (lbs)	List Price EACH (US\$)
31002	1/2"	P x P x FPT	5	120	0.249	\$ 27.63
31004	3/4" x 3/4" x 1/4"	P x P x FPT	5	100	0.254	\$ 36.65
31006	3/4" x 3/4" x 1/2"	P x P x FPT	5	100	0.304	\$ 37.27
31008	3/4"	P x P x FPT	5	100	0.348	\$ 43.90
31010	1" x 1" x 1/2"	P x P x FPT	5	80	0.415	\$ 47.71
31012	1" x 1" x 3/4"	P x P x FPT	5	80	0.493	\$ 55.93
31014	1-1/4" x 1-1/4" x 1/2"	P x P x FPT	1	50	0.529	\$ 69.16
31016	1-1/4" x 1-1/4" x 3/4"	P x P x FPT	1	50	0.595	\$ 70.98
31018	1-1/2" x 1-1/2" x 1/2"	P x P x FPT	1	30	0.809	\$ 83.91
31020	1-1/2" x 1-1/2" x 3/4"	P x P x FPT	1	30	0.901	\$ 115.87
31022	2" x 2" x 1/2"	P x P x FPT	1	20	1.151	\$ 101.59
31024	2" x 2" x 3/4"	P x P x FPT	1	20	1.301	\$ 92.16

**TEE - ADAPTER XL**

31026	2-1/2" x 2-1/2" x 3/4"	P x P x FPT	1	6	1.541	\$ 365.90
31028	2-1/2" x 2-1/2" x 2"	P x P x FPT	1	6	2.150	\$ 407.41
31030	3" x 3" x 3/4"	P x P x FPT	1	4	2.044	\$ 437.84
31032	3" x 3" x 2"	P x P x FPT	1	4	2.778	\$ 482.41
31034	4" x 4" x 3/4"	P x P x FPT	1	2	3.475	\$ 523.02
31036	4" x 4" x 2"	P x P x FPT	1	2	4.295	\$ 549.28

**90 ELBOW MALE ADAPTER**

Part	Size	Type	Bag Qty	Case Qty	Weight EACH (lbs)	List Price EACH (US\$)
31402	1/2" x 3/4"	P x MPT	5	100	0.265	\$ 42.28
31404	3/4" x 1/2"	P x MPT	5	100	0.245	\$ 43.92
31406	1-1/4"	P x MPT	1	30	0.668	\$ 89.23
31408	1-1/2"	P x MPT	1	25	0.961	\$ 123.37
31410	2"	P x MPT	1	14	1.610	\$ 174.83

# CERROPRESS® PRICE LIST

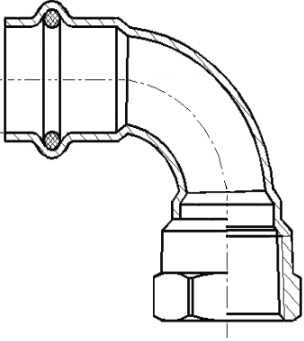

## 90 ELBOW FEMALE ADAPTER

Part	Size	Type	Bag Qty	Case Qty	Weight EACH (lbs)	List Price EACH (US\$)
31502	1/2"	P x FPT	5	150	0.181	\$ 18.32
31504	3/4"	P x FPT	5	100	0.299	\$ 29.41
31506	1"	P x FPT	1	65	0.463	\$ 49.74
31508	1-1/4"	P x FPT	1	30	0.668	\$ 83.73
31510	1-1/2"	P x FPT	1	25	0.961	\$ 109.92
31512	2"	P x FPT	1	14	1.610	\$ 174.68
31514	1/2" x 3/8"	P x FPT	5	150	0.136	\$ 28.82
31516	1/2" x 3/4"	P x FPT	5	100	0.265	\$ 44.21
31518	3/4" x 1/2"	P x FPT	5	100	0.245	\$ 47.03
31520	1" x 1/2"	P x FPT	1	100	0.295	\$ 47.83

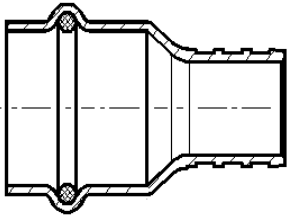

## PEX ADAPTER

Part	Size	Type	Bag Qty	Case Qty	Weight EACH (lbs)	List Price EACH (US\$)
31602	1/2"	P x PEX	10	500	0.059	\$ 7.67
31604	1/2" x 3/4"	P x PEX	10	400	0.088	\$ 12.81
31606	3/4" x 1/2"	P x PEX	10	400	0.088	\$ 14.46
31608	3/4"	P x PEX	10	400	0.097	\$ 13.79
31610	1"	P x PEX	10	250	0.147	\$ 22.62

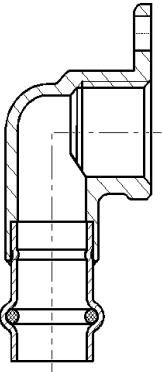

## 90 ELBOW HI EAR

Part	Size	Type	Bag Qty	Case Qty	Weight EACH (lbs)	List Price EACH (US\$)
32502	1/2"	P x FPT	5	160	0.221	\$ 52.91

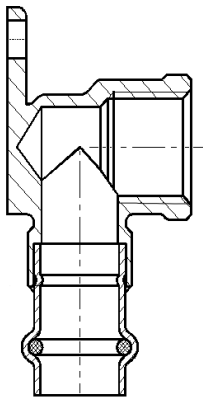

## 90 ELBOW DROP EAR

Part	Size	Type	Bag Qty	Case Qty	Weight EACH (lbs)	List Price EACH (US\$)
32602	1/2" x 3/8"	P x FPT	5	120	0.243	\$ 54.91
32604	1/2"	P x FPT	5	100	0.291	\$ 24.21
32606	3/4"	P x FPT	5	50	0.430	\$ 52.29

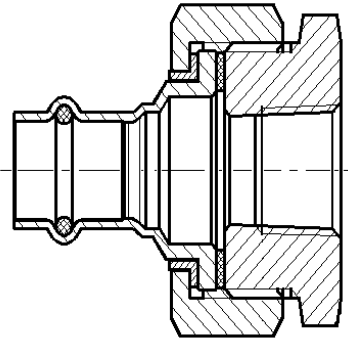

**UNION - CARBON STEEL DI-ELECTRIC**

Part	Size	Type	Bag Qty	Case Qty	Weight EACH (lbs)	List Price EACH (US\$)
32802	1/2"	P x FPT	1	50	0.816	\$ 72.11
32804	3/4"	P x FPT	1	40	1.147	\$ 77.26
32806	1"	P x FPT	1	40	1.041	\$ 99.12
32808	1-1/4"	P x FPT	1	30	1.537	\$ 130.40
32810	1-1/2"	P x FPT	1	20	1.822	\$ 151.71
32812	2"	P x FPT	1	12	2.827	\$ 212.90

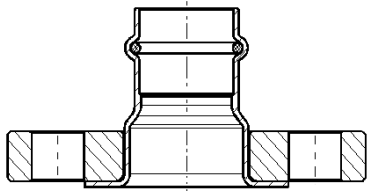

**FLANGE**

Part	Size	Type	Bag Qty	Case Qty	Weight EACH (lbs)	List Price EACH (US\$)
40002	1"	P - BP	1	12	2.800	\$ 206.15
40004	1-1/4"	P - BP	1	12	3.197	\$ 293.98
40006	1-1/2"	P - BP	1	12	3.859	\$ 322.61
40008	2"	P - BP	1	6	5.490	\$ 362.70

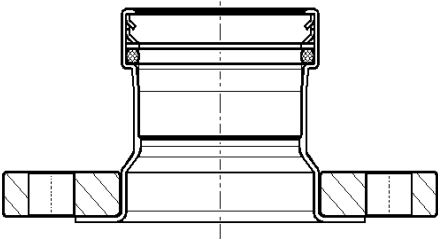

**FLANGE XL**

40010	2-1/2"	P - BP	1	3	6.267	\$ 361.74
40012	3"	P - BP	1	3	7.627	\$ 441.65
40014	4"	P - BP	1	1	11.874	\$ 493.97

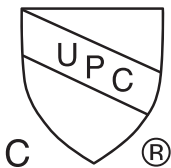

- NSF/ANSI 61-G/372 Lead Free
- ASME B16.51
- Uniform Plumbing Code (cUPC)
- IAPMO PS 117
- ICC ES PMG
- Copper Alloy C12200
- Potable Water
- EPDM O-Ring

For warranty and terms & conditions, please see [www.cerropress.com](http://www.cerropress.com)







CerroPress®  
**PRICE LIST**

Cerro Flow Products LLC  
PO Box 66800  
St. Louis, MO 63166-6800

[cerro.com/cerropress](http://cerro.com/cerropress)

618-337-6000

[sales@cerroflow.com](mailto:sales@cerroflow.com)



A Marmon/Berkshire Hathaway Company